

Armadi KA 1 e 2 ante: Dimensioni larghezza con fianchi montati +10mm
Uniti in batteria: +2mm

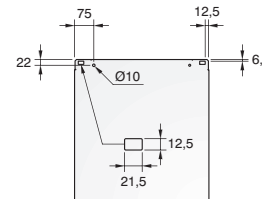

PIASTRA INS. FRONTALE

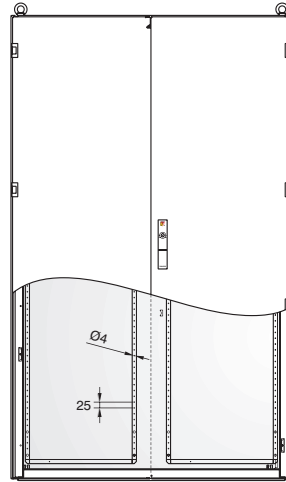
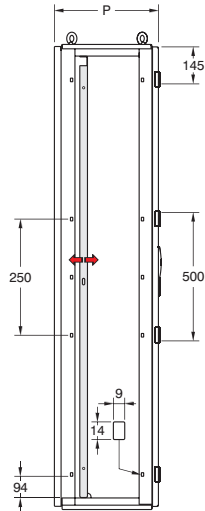
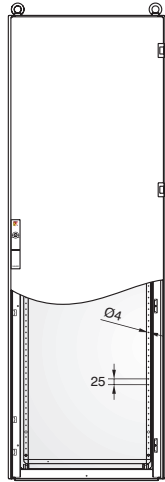
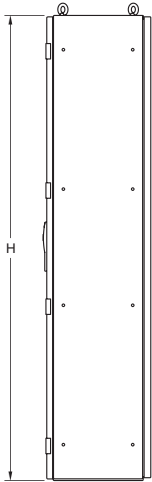
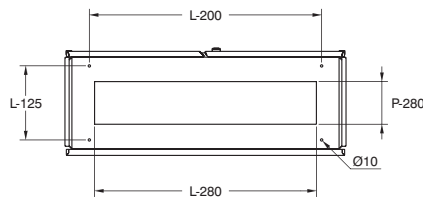
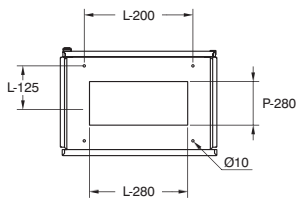
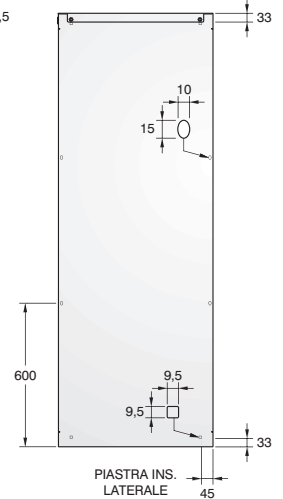

PIASTRA INS. LATERALE

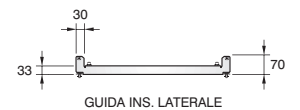
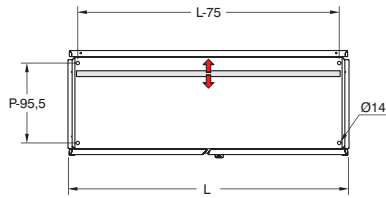
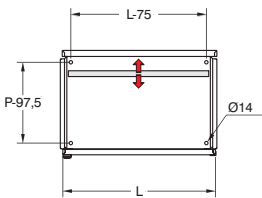

GUIDA INS. LATERALE

DIMENSIONI ARMADI KA

Anta Unica.....	L-10	H-10
Anta Dx.....	½L+3	H-10
Anta Sx.....	½L-25	H-10
Utile Foratura Anta Unica.....	L-160	H-160
Utile Foratura Anta Dx.....	L anta-160	H-160
Utile Foratura Anta Sx.....	L anta-160	H-160
Utile Foratura/Pass. Lat. s/Piastra...	P-150	H-100
Utile Foratura/Pass. Lat. c/Piastra...	P-180	H-100
Luce Utile ad Ante Aperte.....	L-100	H-100
Piastra Interna Frontale.....	L-105	H-105
Piastra Inserimento Laterale.....	L-0	H-105
Superficie Utile Piastra Laterale.....	L-0	H-165
Profondità Utile.....	P-105	
Utile Foratura Base.....	L-150	P-95
Utile Foratura Top.....	L-250	P-95
Utile Foratura Retro.....	L-110	H-120

OMOLOGAZIONI

CE		EN 62208/02:2012	EN 61439-1
	IP 66	EN 62208/02:2012	EN 60 529 ; EN 61439-1
	Anta cieca: IK10	EN 62208/02:2012	EN 62 262 ; EN 61439-1
	Anta vetro: IK08	EN 62208/02:2012	EN 62 262 ; EN 61439-1
	Max Load Capacity	Pl. 900Kg Anta 90Kg	EN 62208/02:2012 EN 61439-1
	TYPE 1, 12	FILE E238294	Standard 508
	NEMA 1, 12	FILE E238294	Standard 250
		2011/65/CE	1272/2008/CE

1 and 2 doors KA cabinets: Width with side panels installed +10 mm
In in-line configurations +2 mm

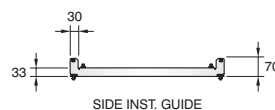
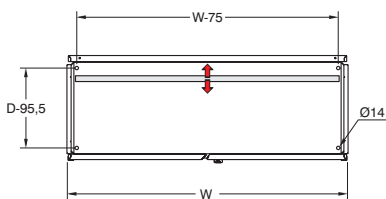
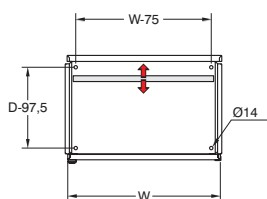
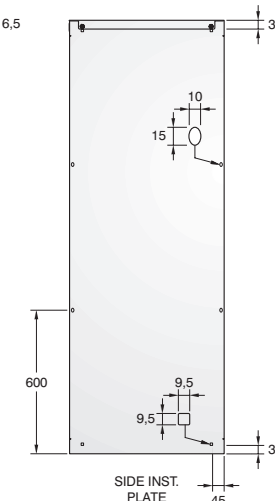
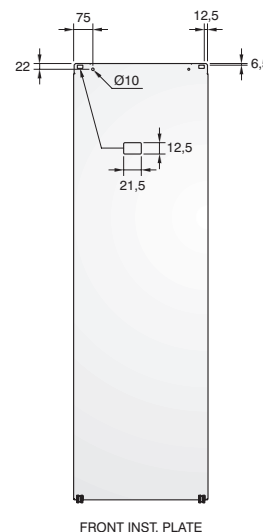
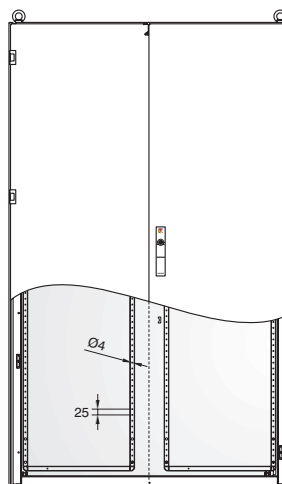
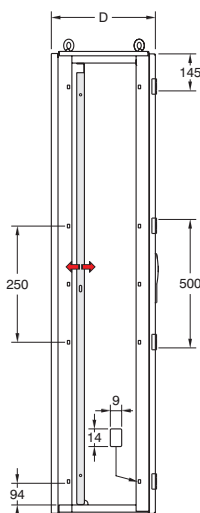
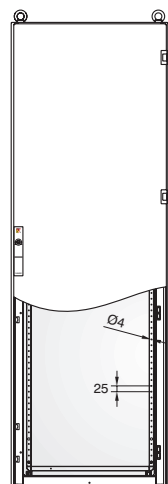
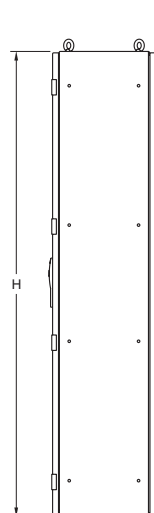
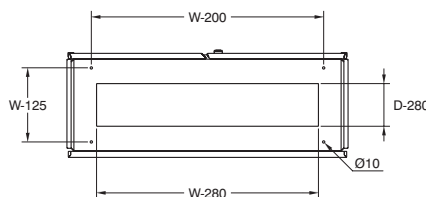
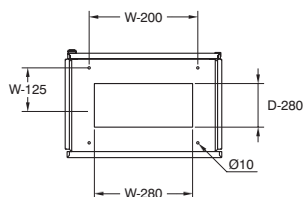

KA CABINETS DIMENSIONS

Single Door.....	W-10	H-10
R Door.....	1/2W+3	H-20
L Door.....	1/2W-25	H-20
Single Door Drill Dimensions.....	W-160	H-160
R Door Drill Dimensions.....	W door-160	H-160
L Door Drill Dimensions.....	W door-160	H-160
Drill Dimensions/Side Spacing with Plate.....	D-150	H-100
Drill Dimensions/Side Spacing without Plate.....	D-180	H-100
Opening Dimensions with Open Doors.....	W-100	H-100
Front Internal Plate.....	W-105	H-105
Side Installation Plate.....	W-0	H-105
Side Plate Useful Area.....	W-0	H-165
Drill Depth.....	D-105	
Base Drill Dimensions.....	W-150	D-95
Top Drill Dimensions.....	W-250	D-95
Back Panel Drill Dimensions.....	W-110	H-120

APPROVALS

CE		EN 62208/02:2012	EN 61439-1
	*IP 55	EN 62208/02:2012	EN 60 529 ; EN 61439-1
	Solid door: IK10	EN 62208/02:2012	EN 62 262 ; EN 61439-1
	Glass door: IK08	EN 62208/02:2012	EN 62 262 ; EN 61439-1
	Max Load Capacity	Pl. 900Kg	EN 62208/02:2012 EN 61439-1
		Door 90Kg	
		2011/65/CE	1272/2008/CE

* IP66 WITH SINGLE, FLAT GROMMET FLANGE

